



APPROVED

Mohan Lal Majee, Planner in-Charge, Building Plan, Durgapur Municipal Corporation

PLAN No. CG/358/15 RB/CB/IB/PB/HU/ APN: 20.17.20.18 Date: 10.03.2017

Commissioner, Durgapur Municipal Corporation

PERMISSION ACCORDED AS PER ACT AND BUILDING PLAN REGULATIONS & S.P. 14 W.B. 2006.

BUILDING PLAN APPROVED ON THE BASIS OF THE CITY BOND, LAND MUTATION & PERMISSION IS THE RESPONSIBILITY OF THE OWNER.

Structural Safety Should be Assured by the Party

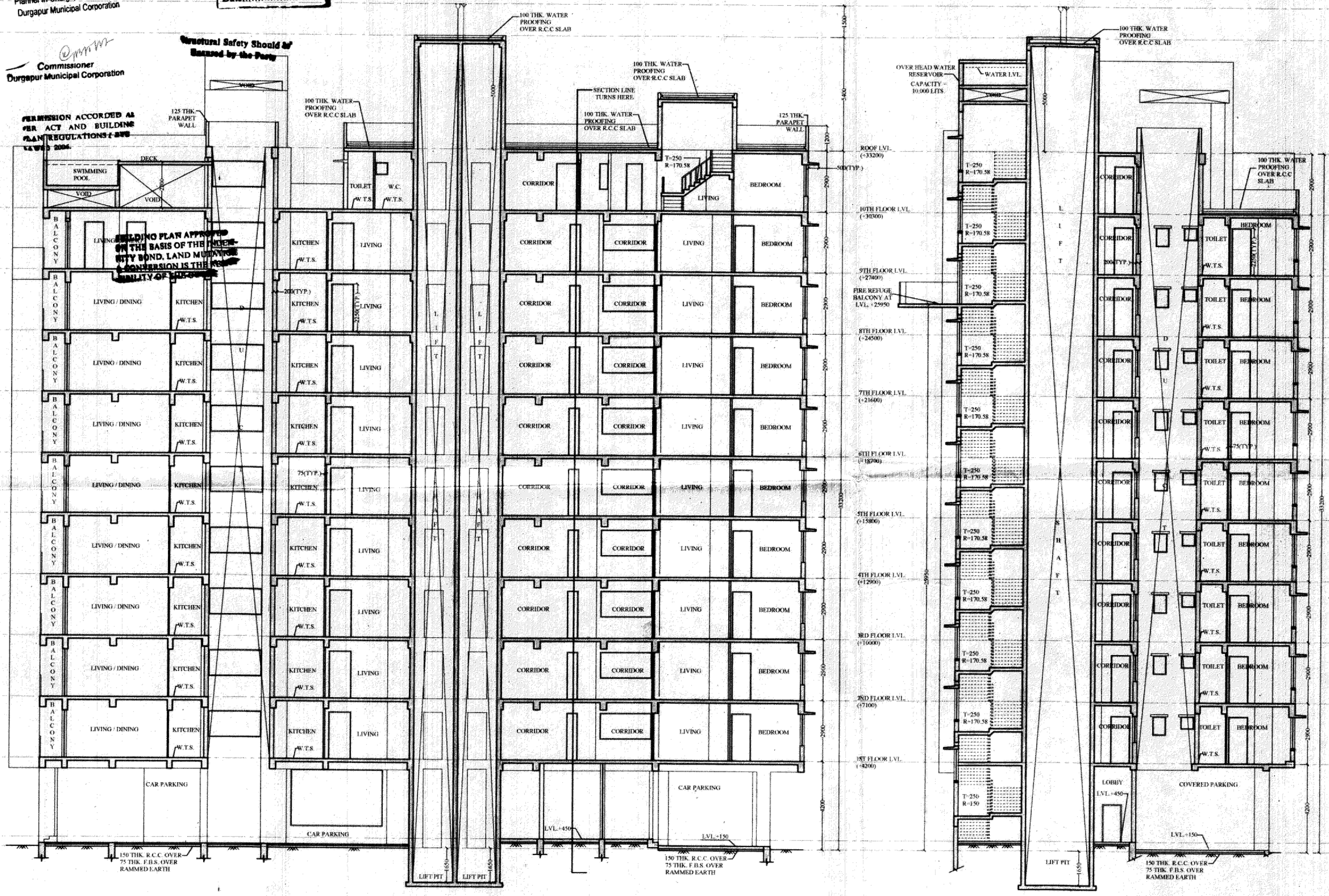

SECTION 2-2 SCALE = 1:100

SECTION 1-1 SCALE = 1:100

SCHEDULE OF DOOR AND WINDOW table with columns for Door Schedule and Window Schedule.

SCHEDULE OF FLOOR FINISHES table with columns for Type, Thickness, and Description.

- NOTES: 1. ALL DIMENSIONS ARE IN MM. UNLESS OTHERWISE NOTED. 2. ALL EXTERNAL BRICK WORKS ARE 200 MM. AND INTERNAL BRICK WORKS ARE 75 MM. UNLESS MENTIONED OTHERWISE RESPECTIVELY AND SHALL BE IN 1:4 CEMENT MORTAR.

Amitava Ghosh, Lakshmi Roy, Joydev Saha, Gopa Dasgupta, Ranjit Basak, Piasha Roy, Mrinal Kanti Mondal, Mithin Dutta, Partha Sarathi Mukherjee, Mrinal Kanti Mondal, Ranjit Roy, Sanyal Roy

THE OWNER(S) WILL REMAIN RESPONSIBLE FOR THE PROVISION OF CENTRAL CORRIDOR WIDTH OF 1500 mm ADOPTED BY US.

LI.A. DECLARATION: Certified with full responsibility that the Building Plan has been drawn up as per provision of D.M.C. Building Rules 2006 as amended from time to time and that the site conditions including the adjoining road conditions with the Plan which has been measured and verified by me.

Signature of Architect: ADITYA GOSWAMI, M. Arch. Regd. No. GA/2004/3103 Registered with the Council of Architecture, India.

Signature of Architect: ADITYA GOSWAMI M. Arch. Regd. No. CA/2004/3103 Registered with the Council of Architecture, India.

S.E. Declaration: The structural design and drawing of both foundation and super structure of the building has been made by me considering all possible load including seismic load as per National Code of India and certified that it is safe and stable all respect.

Signature of Structural Engineer: ASHIM KUMAR DAS Structural Consultant B.C.E. M.I.E. OF N.I.G.S.A.S.C. FELLOW INSTITUTE. M-140550-5

SPACE FOR SEAL:

TITLE: MUNICIPAL ARCHITECTURAL DRAWING 05

PROJECT NAME:

PROPOSED G +10 RESIDENTIAL BUILDING OF 1. AMITAVA GHOSH, 2. LAKSHMI ROY, 3. JOYDEV SAHA, 4. GOPA DASGUPTA, 5. RANJIT BASAK, 6. PIASHA ROY, 7. TUHIN KANTI MONDAL, 8. MITHIN DUTTA, 9. PARTHA SARATHI MUKHERJEE, 10. MRINAL KANTI MONDAL, 11. SANJIB ROY, R.S. PLOT NO. - 228 (P); KHATIAN NO. - 717,755,715,756,721,716,722,719,718,720,713; L.R. PLOT NO. - 72 (P), J.L. NO. - 001, OLD J.L. NO. - 76, MOUZA - PARDAL, BLOCK - FARIDPUR - DURGAPUR, P.S. - NEW TOWNSHIP, DIST. - BURDWAN.

- AVIATION LIGHT
LIGHTNING ARRESTER

Table with columns for DATE, SCALE, DRG. NO., DRAWN BY, APPROVED.

CONSULTANT: Architectonic Services ARCHITECTS ENGINEERS URBAN DESIGNERS 18B, LAKE VIEW ROAD, 1ST FLOOR, KOLKATA - 700 029 PHONE: (033)-6451-6357, (033)-4008-0483 Email: architectonic@gmail.com

W.T.S. = WATER TIGHT SLAB



BURDWAN HOUSING DEVELOPMENT PROJECT

Srimanta Nayak Consulting Civil Engineer Durgapur Municipal Corporation Steel Park More, Durgapur-6 LIC No. - D.M.C./BPD/21 Dated: 10.10.16